



BENEFITS

- **Smart pH:** predictive regulation according to the history for a perfectly stable pH
- **IPS HD panel** for optimal display quality
- **Dynamic backlit capacitive keys** for easy navigation
- **Automatic brightness adjustment** via light sensor
- **Automatic standby output** by presence sensor
- **Colour-coded display of the pool status:** blue: optimal water quality, orange: information message, red: alarm
- **Indicators of the status of the device's functions** using pictograms (OFF, STOP, INJ...)
- **Simultaneous display** of setpoints measured pH value and water temperature
- **High quality, factory tested and calibrated Black pH probe**
- **Bluetooth remote control** with e-Pool[®] app

FEATURES

- **Predictive and proportional pH control based on injection history**
- **Automatic injection of correcting agent**, acid (pH-) or base (pH+)
- **Safeties:** pH setpoint overrun and overfeeding : cause of malfunction indicated by written message
- **Log of events**
- **Multilingual communication interface**
- **Easy installation and assembly**

Model	Pool volume* (m³)	Pump flow (/h)	Reference
Poolsquad pH	160	1,8	REGU23NPSP-G5

Technical specifications	
Display	IPS HD panel
Screen size	4,3 inches
Keyboard type	capacitive keys
Presence sensor range (cm)	20
Corrective solution	pH- or pH+
pH regulation type	predictive
pH pump type	peristaltic
Setpoint adjustment	6,8 to 7,6
pH probe calibration	2 points pH 7 and pH 10
pH probe	Black
Control panel size (mm)	W 140 x H 300 x D 97

INSTALLATION DIAGRAM

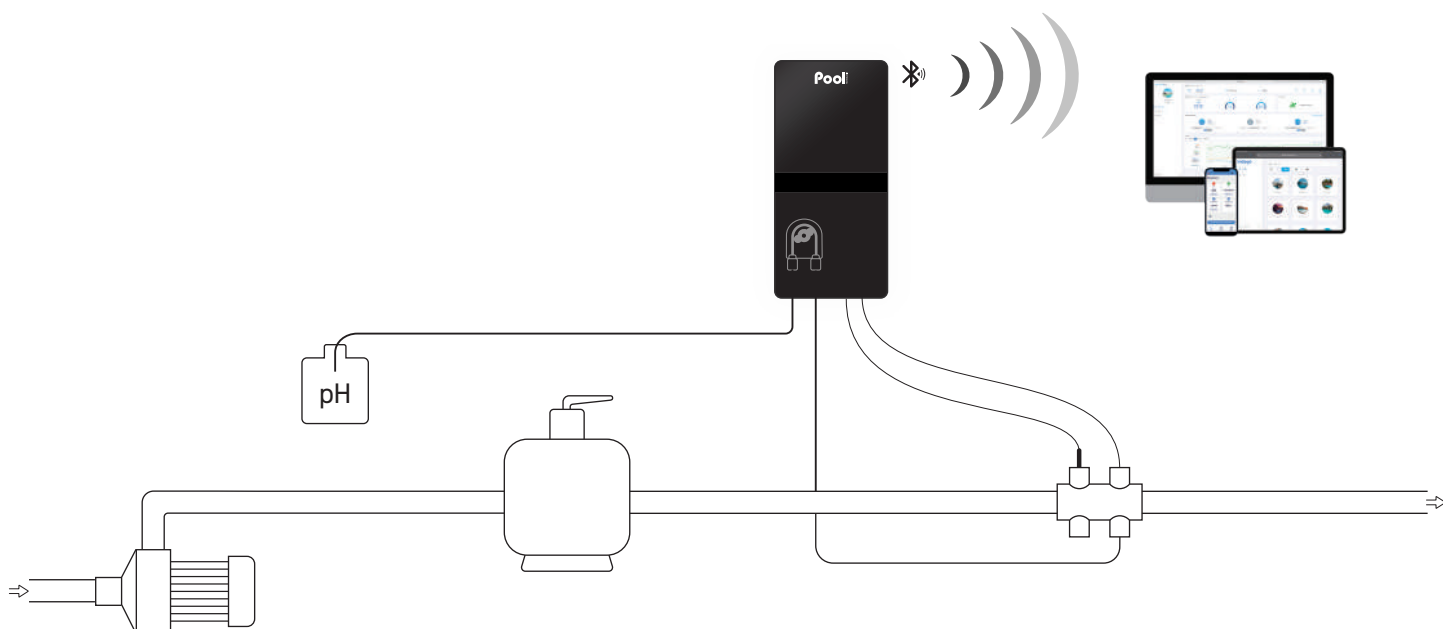

CONTENT

- Control box
- pH Black probe
- Calibration solutions pH 7 & pH 10
- Probe holder, injection connector
- Temperature sensor
- Accessories holder with plugs
- Power cable (2 m)
- Reducer Ø 63/50 mm x2
- Wall support (with screws)

OPTIONS

- Empty pH can sensor
- e-Pool® Connect connected Pool Kit

WARRANTIES

2 years	Box
3 years	Probe pH Black